

CONTRACTORS MUST VERIFY ALL DIMENSIONS ON SITE BEFORE COMMENCING ANY WORK OR PREPARING SHOP DRAWINGS

All Architectural drawing sheets to be cross-referenced with other relevant disciplines.

Rev	Description	Date
-----	-------------	------

- NOTES:
- AERIAL SITE PLAN IS NOT TRUE TO SURVEY
 - SUN ELEVATION FOR 3.00PM 22ND JUNE 2025 = 18.75°
 - SUN AZIMUTH FOR 3.00PM 22ND JUNE 2025 = 318.94°
 - LANDSCAPING IS INDICATIVE ONLY
 - EACH VIEWPOINT IS CAPTURED AT 1.6m ABOVE THE NOMINATED AHD RL. THE VIEWPOINTS ARE PERSPECTIVE VIEWS ARE NOT SHADOW DIAGRAMS.



1 SITE PLAN WITH AERIAL
1:500

NOTE: SCALE IS 1:1000 @ A3



CONSULTANT 4:

WEBB AUSTRALIA GROUP (NSW) PTY LTD
LEVEL 2 17 BOLTON STREET
NEWCASTLE NSW 2300 AUSTRALIA
T +61 2 4929 5225 | M +61 428 412 035
MECHANICAL ENGINEERING

CONSULTANT 3:

GLENN HAIG & PARTNERS
Coffs Harbour
P: 62 6658 2444 P: 62 9310 1952
PO Box 192 PO Box 689
SAWTELL, NSW, 2452 SURRY HILLS, NSW, 2010
HYDRAULIC + FIRE CONSULTANTS office@glennhaig.com.au

CONSULTANT 2:

SPECTRUM
1 Davis Place
Glenhaven NSW 2156
ENGINEERING SOLUTIONS
Phone: (02) 8850 6802
Mobile: 0419 294 533
Email: nash@spectrumengineering.com.au

CONSULTANT 1:

PM DESIGN GROUP
20 Ghiesbreght Street
Geelong, Victoria, Australia 3320
PH: 03 5249 4800
E: pm@pmdesign.com.au
STRUCTURAL + CIVIL ENGINEERING

DESIGN ARCHITECT:

FACILITY DESIGN GROUP
NSW Reg. No. 7168
ABN: 75 030 999 624
E: info@fdg.com.au
W: www.fdg.com.au
P: 02 4444 0777
PO Box 62,
Cammerlang NSW 2540
AQUATIC ■ SPORTS ■ LEISURE ■ CIVIC ■ PROJECT MANAGEMENT

CLIENT:

Snowy Valleys Council

PROJECT NAME:

MULTIPURPOSE + EVACUATION CENTRE

FOR DA

PROJECT ADDRESS:
RICHMOND PARK, TUMUT NSW
Lot 1 Section 81 DP 759004 and
Lot 701 DP 1059193.

DRAWING TITLE:

AERIAL SITE PLAN + VIEWPOINTS

A1 PRINT SIZE

SHEET ISSUE DATE: 06/18/25

REVISION DATE:

SCALE: As indicated @ A1

JOB NO.: W366

DRAWN BY: Author CHECKED BY: S. JOHANSSON

COPYRIGHT FACILITY DESIGN GROUP PTY. LIMITED. ALL RIGHTS RESERVED. DO NOT SCALE OFF DRAWINGS. WORK TO FIGURED DIMENSIONS ONLY. VERIFY DIMENSIONS ON SITE PRIOR TO COMMENCING WORK.

NOMINATED ARCHITECT: STEPHEN JOHANSSON - NSW REG No. 7168
20/06/2025 12:04:14 PM

Tumut Evac & Multipurpose Facility

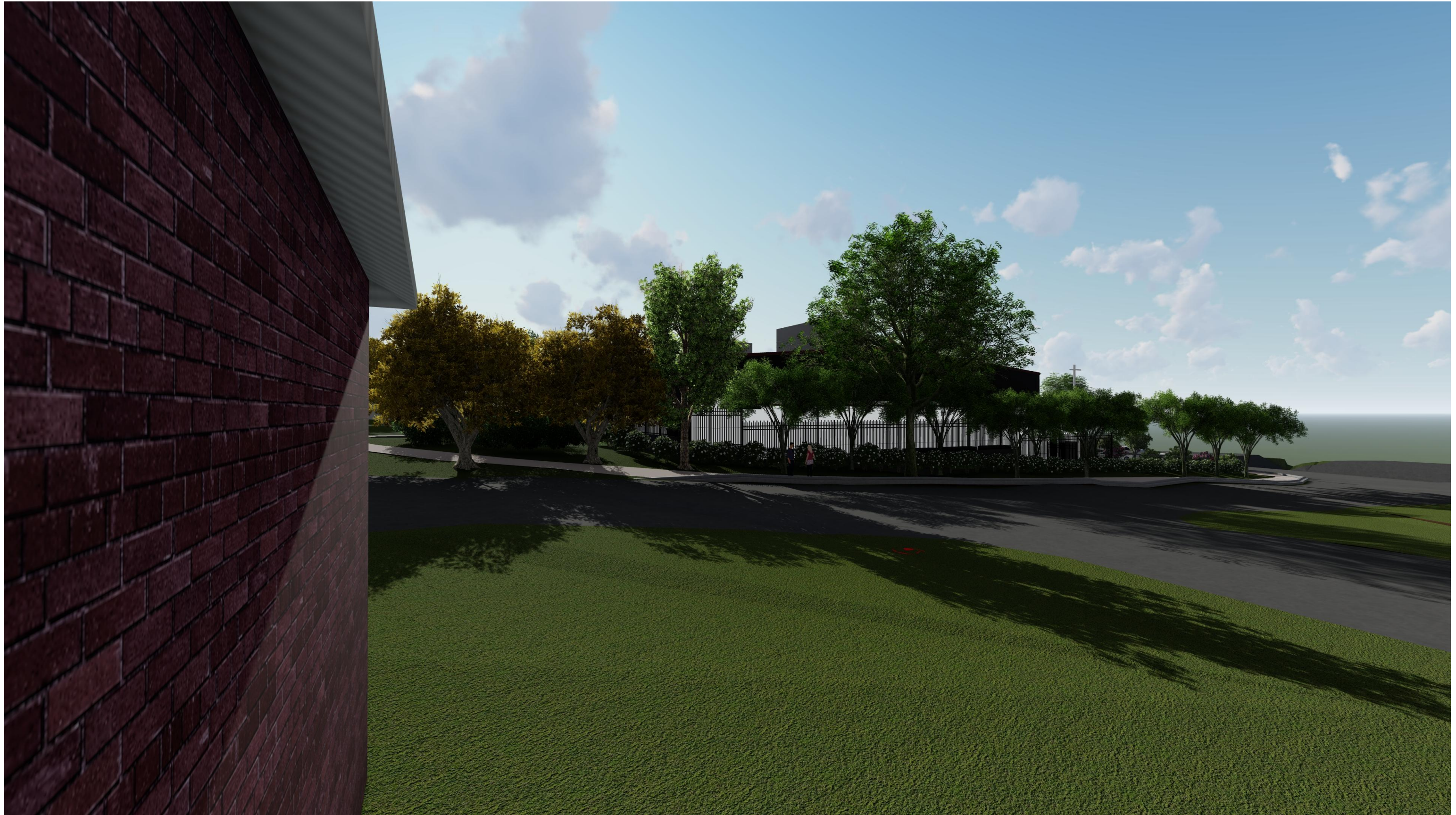

VIEWPOINT 1 - 1 CLUNIE AVENUE

Tumut Evac & Multipurpose Facility

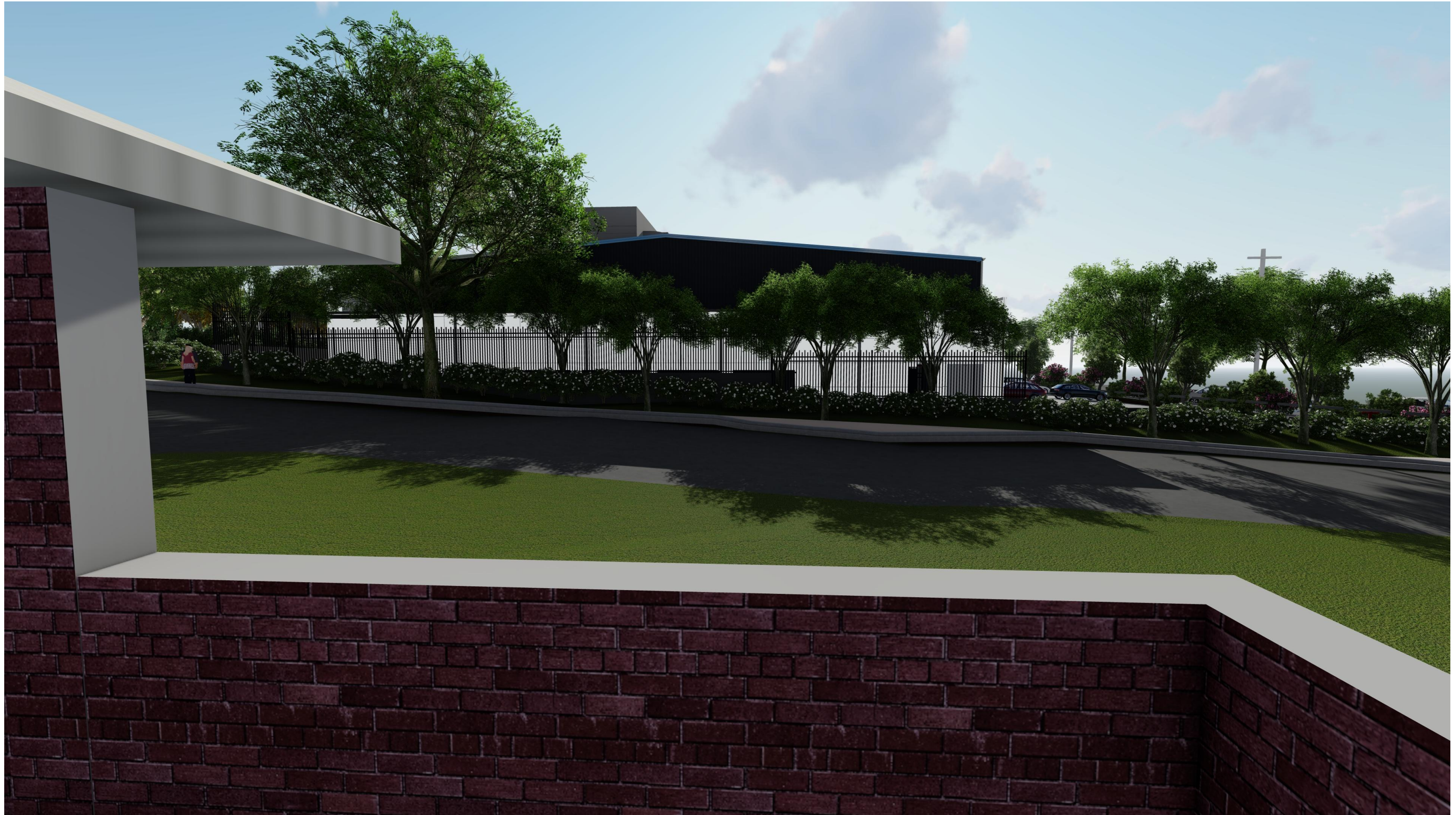

VIEWPOINT 2 - 4 ROBERTSON STREET

Tumut Evac & Multipurpose Facility

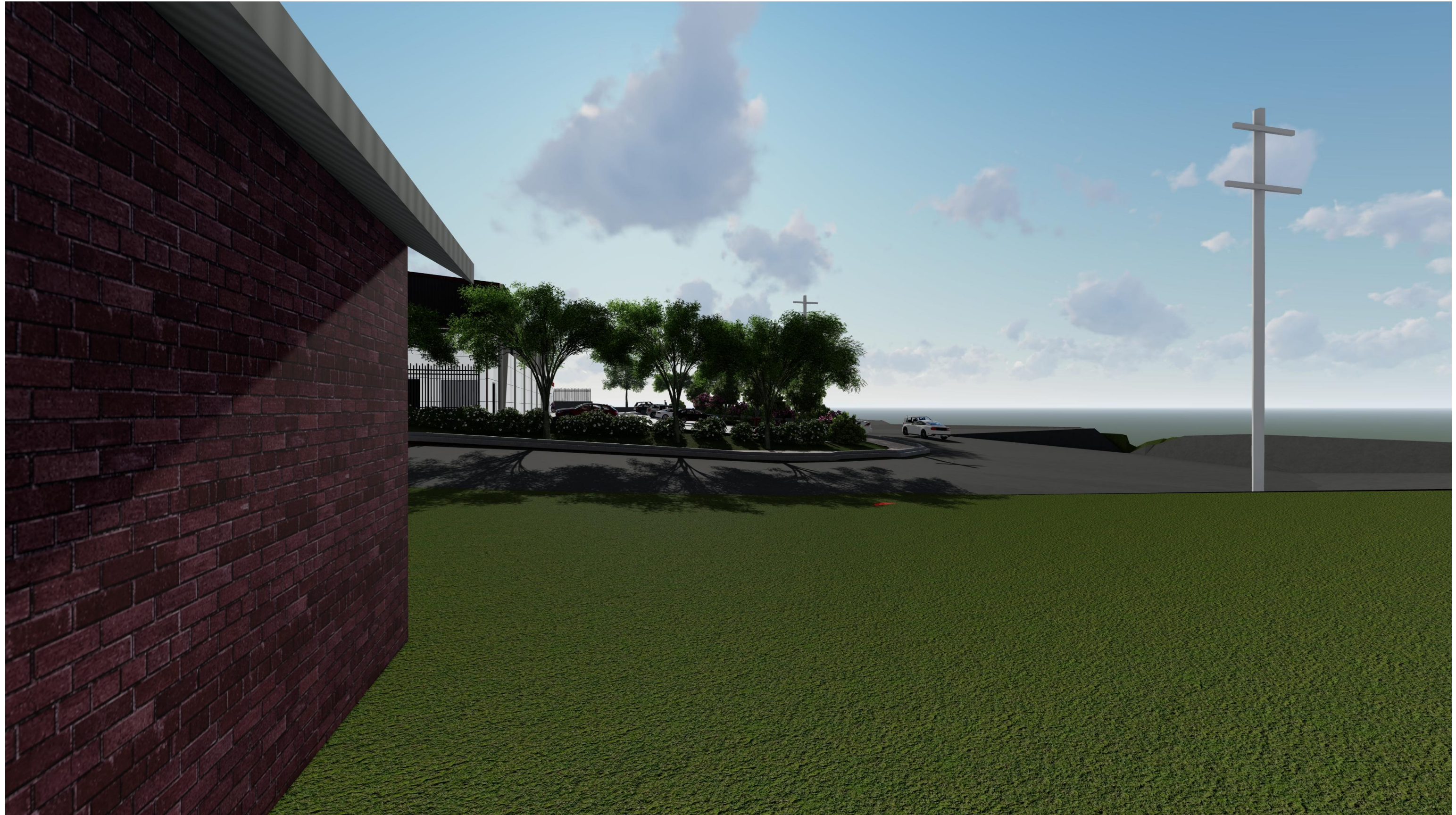

VIEWPOINT 3 - 2 ROBERTSON STREET

Tumut Evac & Multipurpose Facility



VIEWPOINT 4 - 29 RICHMOND STREET

Tumut Evac & Multipurpose Facility



VIEWPOINT 5 - 31 RICHMOND STREET

Tumut Evac & Multipurpose Facility



VIEWPOINT 6 - 33 RICHMOND STREET

Tumut Evac & Multipurpose Facility

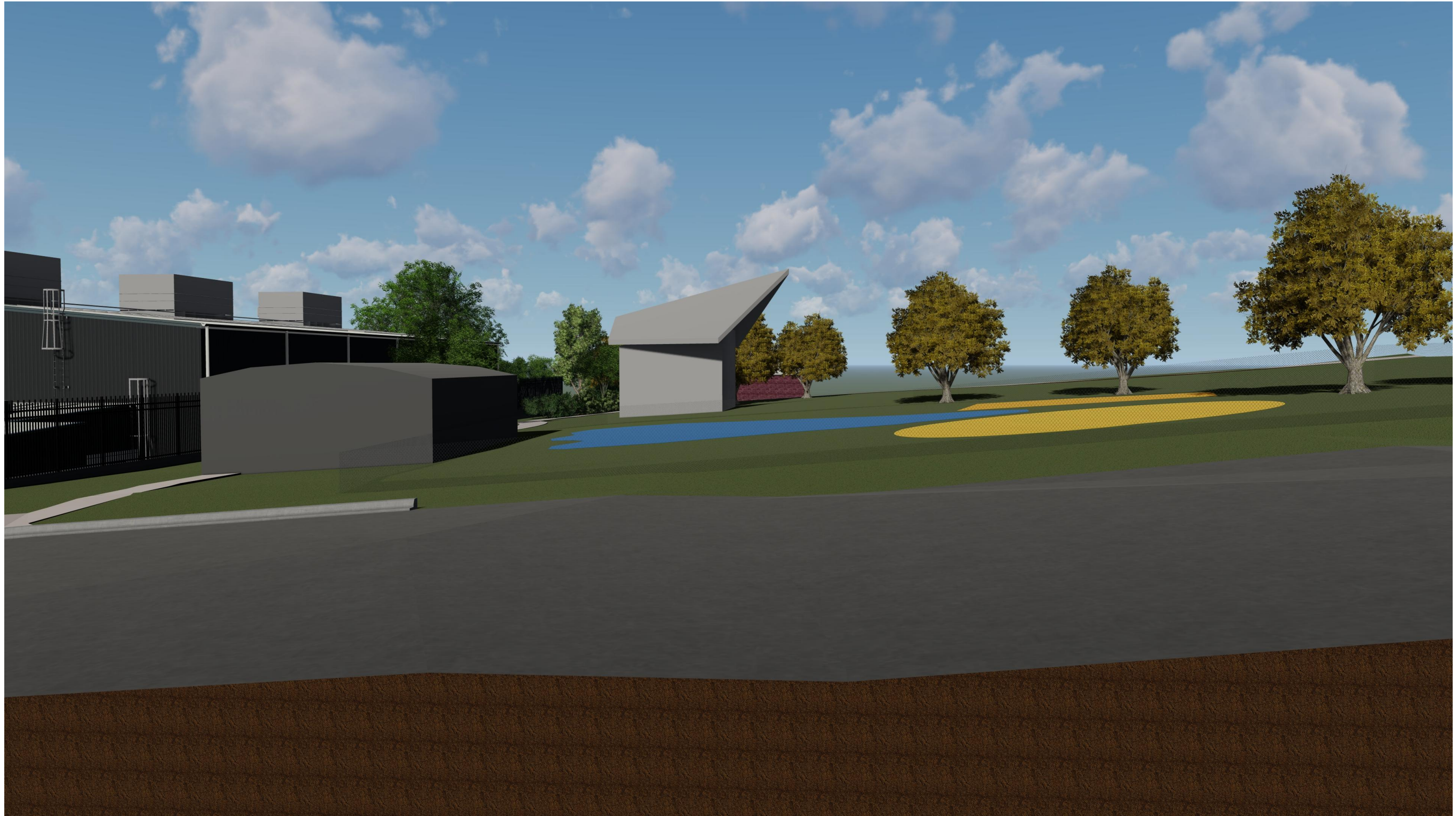

VIEWPOINT 7 - 35 RICHMOND STREET

Tumut Evac & Multipurpose Facility

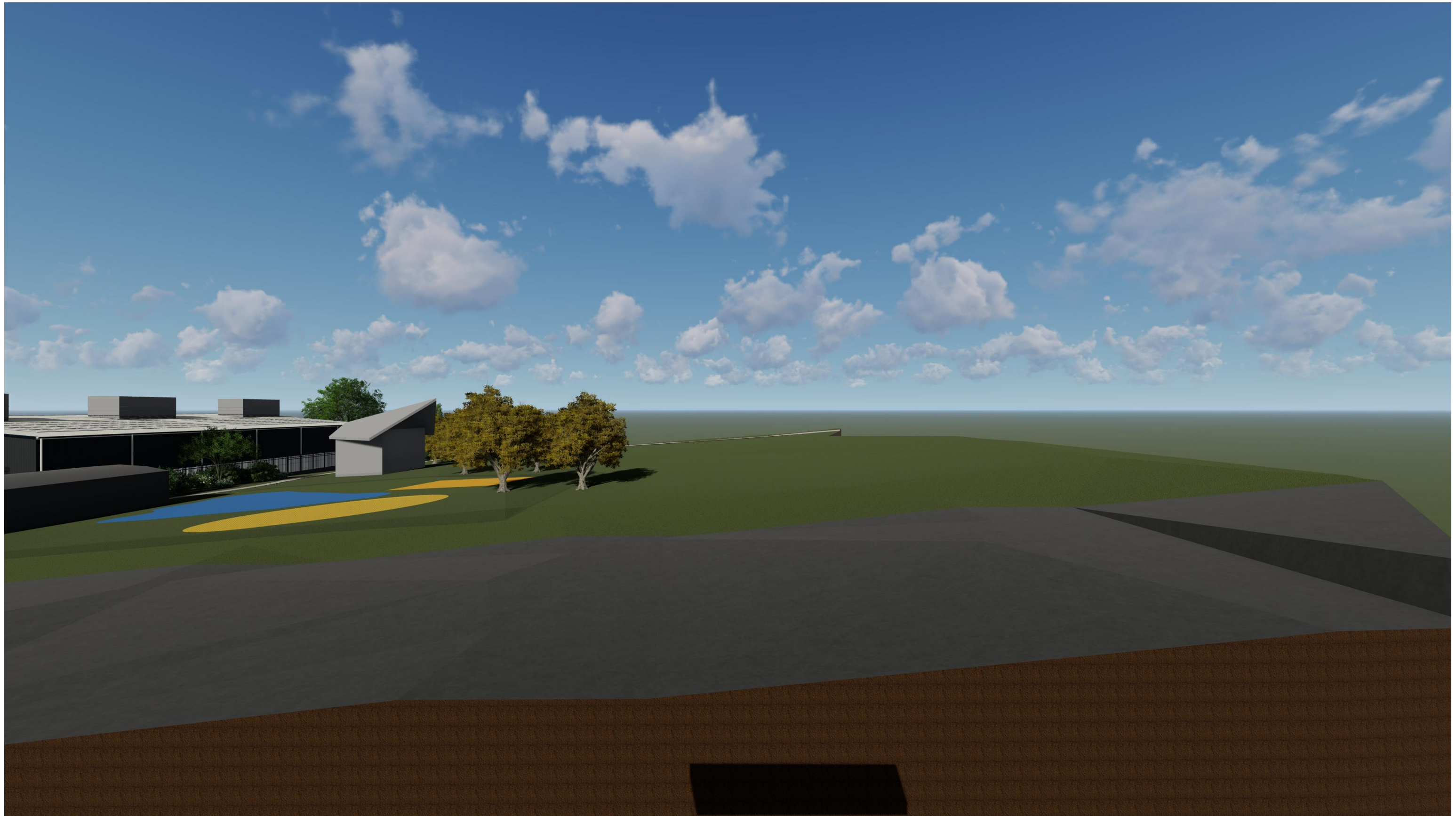

VIEWPOINT 8 - 37 RICHMOND STREET

Tumut Evac & Multipurpose Facility

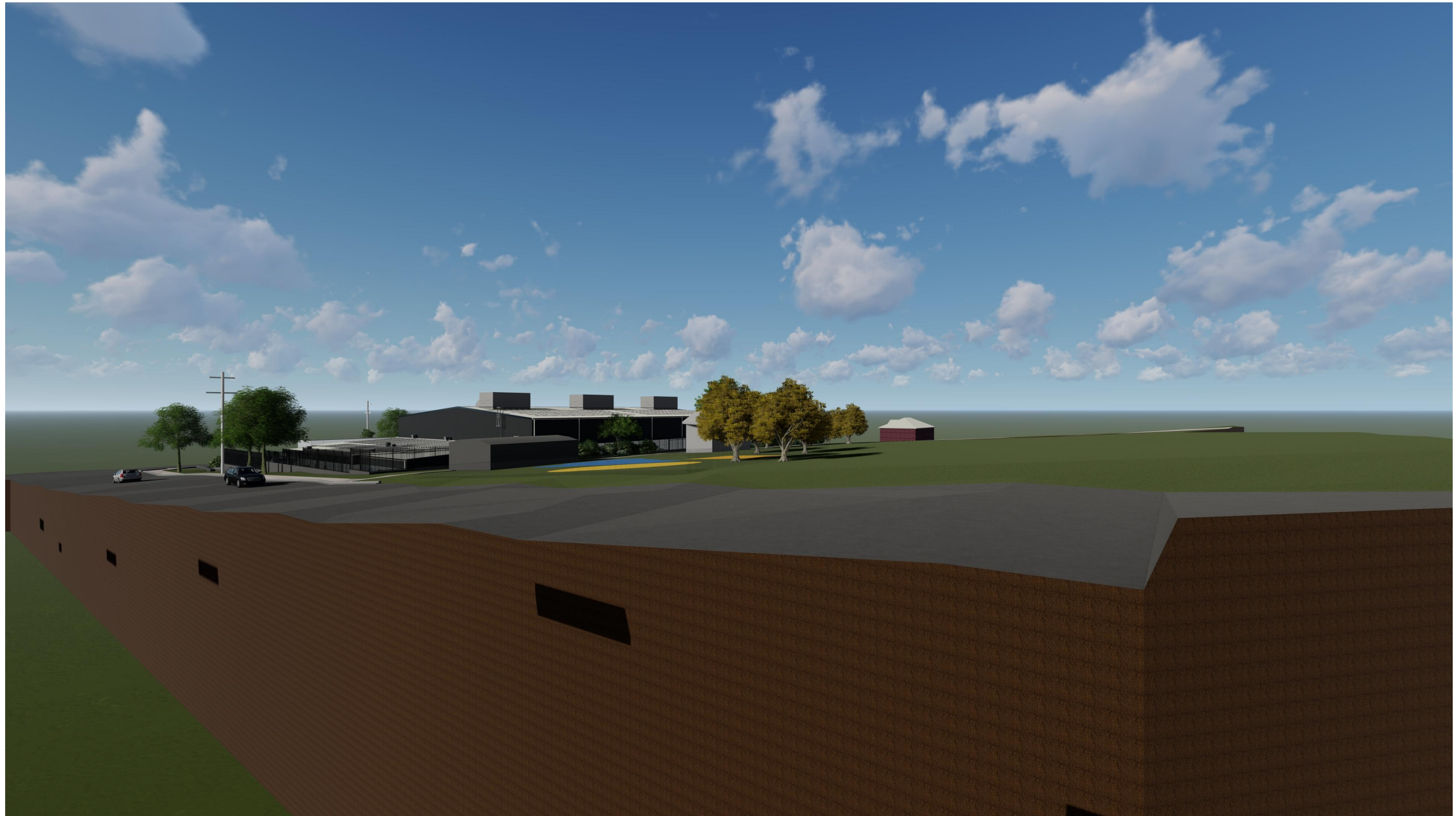

VIEWPOINT 9 OBLIQUE - 39 RICHMOND STREET

Tumut Evac & Multipurpose Facility



VIEWPOINT 10 - CNR RICHMOND & RUSSELL STREETS

Tumut Evac & Multipurpose Facility



VIEWPOINT 11 - CNR RUSSELL & ROBERTSON STREETS